

Compass

Mechanical turnstiles



The ideal range for controlling pedestrian access

- Compass is the simple, inexpensive solution for guiding flows in an orderly, efficient way in any size of shopping centre, from small shops to hypermarkets.
- It can also be used in swimming pools, sports centres, fitness/wellness centres, amusements parks, etc.
- Mechanical turnstile with four arms, enabling one person at a time to pass through in both directions.
- The AISI 304 steel structure makes Compass a product suitable for outdoor installations.

Dimensions (mm)

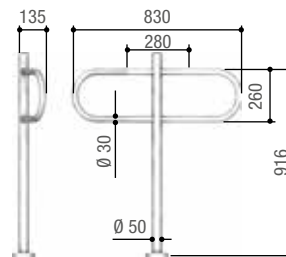
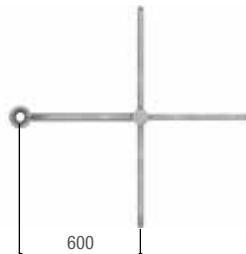
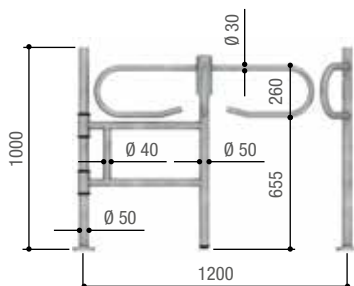

PSOPG01 - PSOPG01X

THE COMPLETE RANGE



Code	Description	Price £ (Excl. VAT)
-------------	--------------------	--------------------------------

Mechanical turnstiles		
001 PSSPCWO	Movable mechanical turnstile with right-hand post. To be fixed to the floor.	£1,139.00
001 PSSPCCW	Movable mechanical turnstile with left-hand post. To be fixed to the floor.	£1,139.00
001 PSSPFMCWO	Fixed mechanical turnstile with right-hand post. To be fixed to the wall.	£1,035.00
001 PSSPFMCCW	Fixed mechanical turnstile with left-hand post. To be fixed to the wall.	£1,035.00



Accessories		
001 PSOPG01	AISI 304 steel channeller, galvanised steel fixing flange and chrome-plated palstic flange cover.	£219.00
001 PSOPG01X	AISI 304 steel channeller, fixing flange and flange cover.	£245.00

